

UA-SHT DC CURRENT Shunt

ORDERING INFORMATION

UA-SHT- [Type] - [Amp] / [Signal] - [Accuracy]

CODE	TYPE	CODE	AMP	CODE	AMP	CODE	AMP	CODE	AMP	CODE	AMP	CODE	AMP	CODE	Signal	CODE	Accuracy
A		0010	10A(*A)	0060	60A(*A)	0250	250A(*B)	0800	800A(*C)	2000	2000A(*D)	5000	5000A(*E)	050	50mV	100	1.0%
B		0020	20A(*A)	0080	80A(*A)	0300	300A(*B)	1000	1000A(*C)	2500	2500A(*D)	6000	6000A(*E)	060	60mV		
C		0030	30A(*A)	0100	100A(*A)	0400	400A(*B)	1200	1200A(*C)	3000	3000A(*D)	xxxx	Specify	075	75mV		
D		0040	40A(*A)	0150	150A(*A)	0500	500A(*B)	1500	1500A(*C)	4000	4000A(*D)	*A: Type A; *B: Type B		100	100mV		
E		0050	50A(*A)	0200	200A(*A)	0600	600A(*B)	3000	3000A(*D)			*C: Type C; *D: Type D		xxx	Specify mV		
												*E: Type E					

TYPE A 10A through 200A / 50mV Standard Accuracy ±1.0%

DIMENSIONS

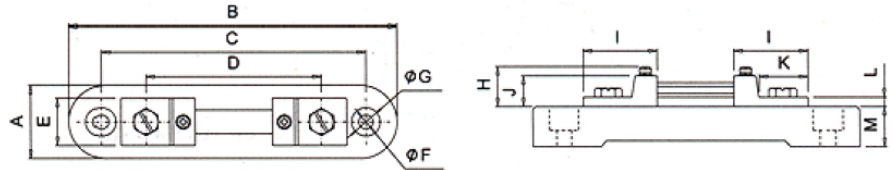

MODEL	A	B	C	D	E	F	G	H	I	J	K	L	M
UA-SHT-A-10A~125A	30	135	110	70	20	6	12	17	32	12	20	5	10
UA-SHT-A-150A~200A	30	135	110	70	20	6	12	20	29	15	--	--	10

*Dimensions subject to change without notice. Please check with our sales dep. before placement drawing.

TYPE B 250A through 600A / 50mV Standard Accuracy ±1.0%

DIMENSIONS

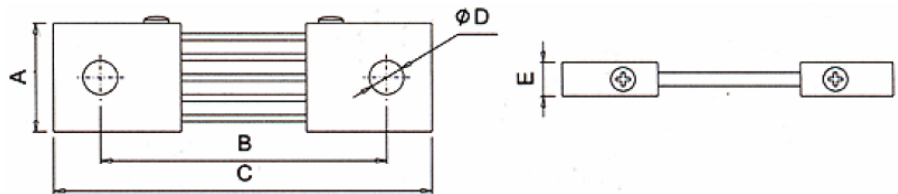

MODEL	A	B	C	D	E
UA-SHT-B-250A~	35	83	115	13	18.5
UA-SHT-B-300A~	35	83	115	13	18.5
UA-SHT-B-400A~	44	83	115	13	18.5
UA-SHT-B-500A~	55	83	115	13	18.5
UA-SHT-B-600A~	55	86	121	13	21

*Dimensions subject to change without notice. Please check with our sales dep. before placement drawing.

TYPE C 800A through 1500A / 50mV Standard Accuracy ±1.0%

DIMENSIONS

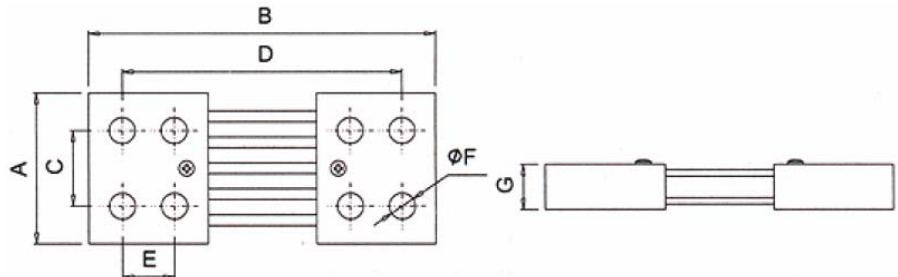

MODEL	A	B	C	D	E	F	G
UA-SHT-C-800A~	70	120	35	88.5	--	13	21
UA-SHT-C-1000A~	70	161	35	121	--	14	21
UA-SHT-C-1200A~	85	162	45	123	--	14	21
UA-SHT-C-1500A~	100	159	50	118	--	14	21

*Dimensions subject to change without notice. Please check with our sales dep. before placement drawing.

TYPE D 2000A through 4000A / 50mV Standard Accuracy ±1.0%;

■ DIMENSIONS

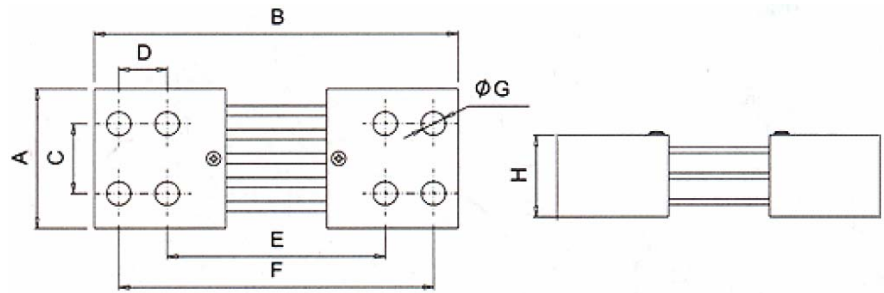

MODEL	A	B	C	D	E	F	G	H
UA-SHT-D-2000A~	100	191	50	37	90	164	14	39
UA-SHT-D-2500A~	110	191	55	37	90	164	14	39
UA-SHT-D-3000A~	125	191	60	37	90	164	14	39
UA-SHT-D-4000A~	140	191	70	37	90	164	14	39

*Dimensions subject to change without notice. Please check with our sales dep. before placement drawing.

TYPE E 5000A through 6000A / 50mV Standard Accuracy ±1.0%;

■ DIMENSIONS

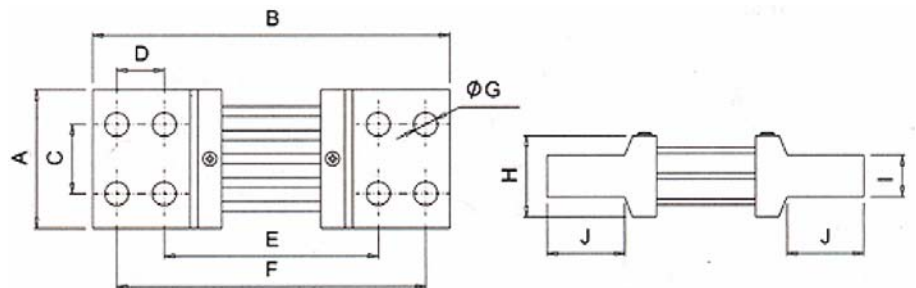

MODEL	A	B	C	D	E	F	G	H	I	J
UA-SHT-E-5000A~	125	315	61	54	165	272	17	105	41	100
UA-SHT-E-6000A~	130	327	65	55	175	282	18.5	114	48	108

*Dimensions subject to change without notice. Please check with our sales dep. before placement drawing.